

# CARTON TRAX

STEEL AXLE PREMIUM CARTON FLOW



Free-floating axle spins independently of wheel with lower coefficient of friction and smoother, more reliable flow.

Sturdy design for lower maintenance costs.

Quick installation with no tools or hardware required.

Save on freight by shipping your complete carton flow project from one manufacturer.

Heavy-duty steel axle carton flow tracks

Abuse-resistant polyethylene rollers

Chromate coated axles provide greater corrosion resistance and smoother flow

Galvanized side channels

Perfect for freezer applications



Larger diameter wheels for more contact surface area



UNARCO

*It just flows better*

[WWW.UNARCORACK.COM/CARTONTRAX.HTML](http://WWW.UNARCORACK.COM/CARTONTRAX.HTML)



# CARTON TRAX

STEEL AXLE PREMIUM CARTON FLOW

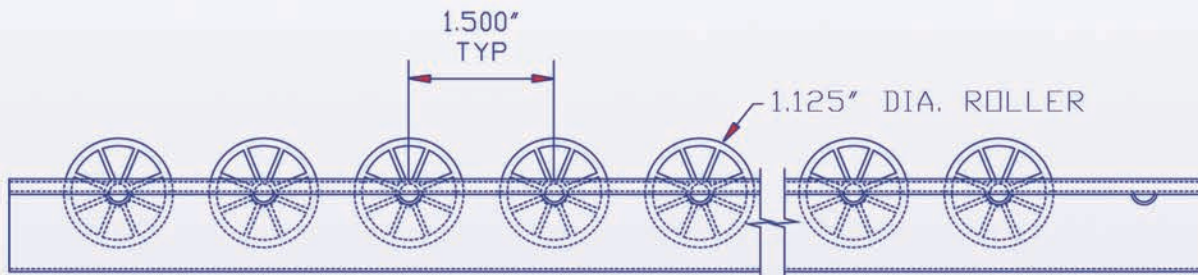

SIDE VIEW OF CARTON FLOW TRACK

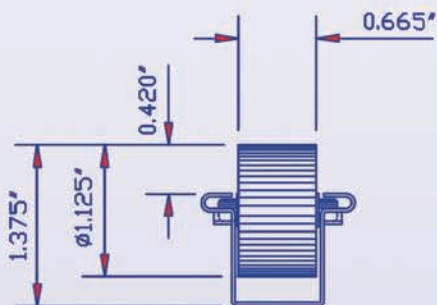

FRONT VIEW

Specially engineered steel axle tooth design allows closer wheel placement for more reliable flow.

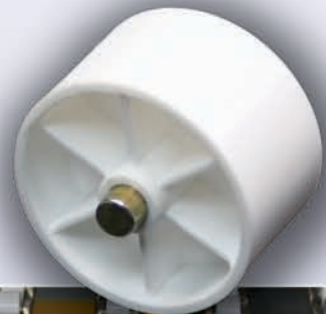

Easy installation and quick adjustability as carton sizes and configurations change.



Fits into UNARCO U-PICK and Kingway K-PICK carton flow shelf designs.



**UNARCO**

Manufactured by:  
**UNARCO Material Handling, Inc.**

701 16th Avenue East  
Springfield, Tennessee 37172  
1-800-862-7261

Plant Locations:  
Tennessee, Texas and Ohio

[WWW.UNARCORACK.COM/CARTONTRAX.HTML](http://WWW.UNARCORACK.COM/CARTONTRAX.HTML)